

Technical specification

Mounting torque: max. 25 Nm
Ambient temperature: -40°C ... +125°C
Media temperature: -50°C ... +135°C

Type label description

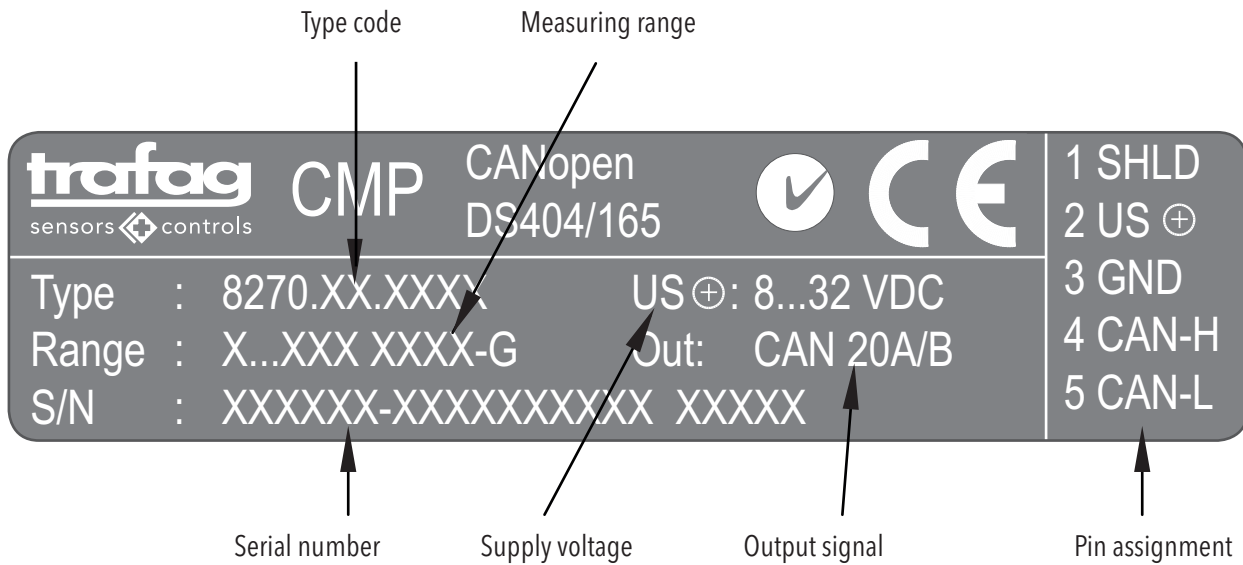

Electrical connections

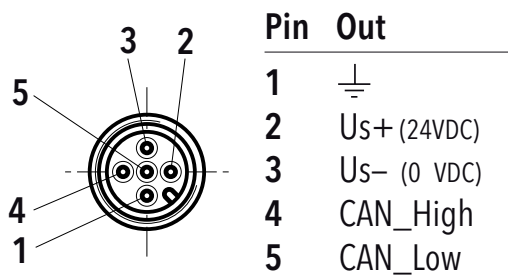

CANopen-protocol

Output signal:	CAN BUS (ISO 118982)
CANopen:	DS-301 V4.0
Device profile:	DS-404 V1.2
Baudrate:	10kbit/s...1Mbit/s, Auto
Error control:	Nodeguarding, Heartbeat
Node ID:	LSS (DSP 305 V2.0) full implemented, proprietary
No. of PDO's:	4 Tx
PDO modes:	event-/time-triggered remotely requested sync (cyclic), sync (acyclic)
PDO linking:	yes
PDO mapping:	yes
No. of SDO's:	1 server
Emergency message:	yes
CiA certified:	yes

Electrical connections

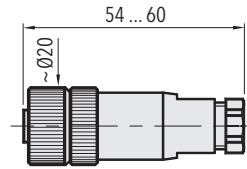
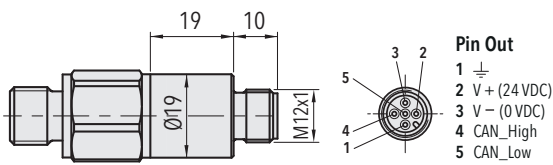

8270.XX.XXXX.35.XX.XX

8270.XX.XXXX.XX.XX.33

Pressure connections

Relative pressure $\leq 0 \dots 2.5$ bar

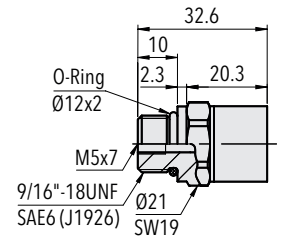
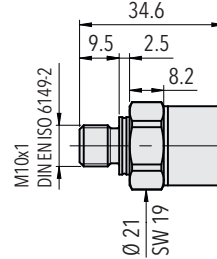
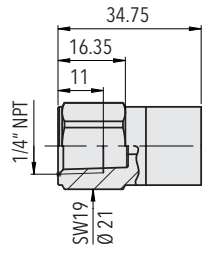
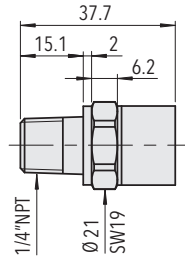
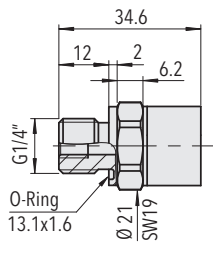

8270.XX.2X17.XX.XX.XX

8270.XX.2X30.XX.XX.XX

8270.XX.2X13.XX.XX.XX

8270.XX.2X32.XX.XX.XX

8270.XX.2X61.XX.XX.XX

Relative pressure $> 0 \dots 2.5$ bar

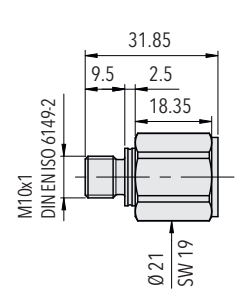
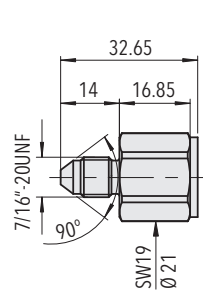
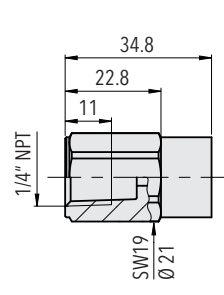
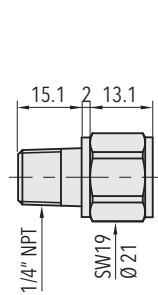
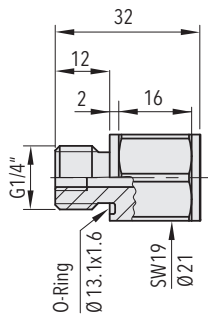

8270.XX.2X17.XX.XX.XX

8270.XX.2X30.XX.XX.XX

8270.XX.2X13.XX.XX.XX

8270.XX.2X18.XX.XX.XX

8270.XX.2X32.XX.XX.XX

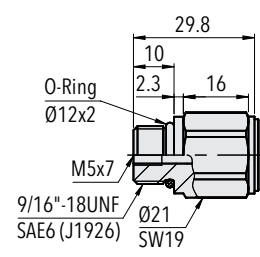
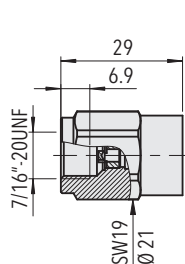
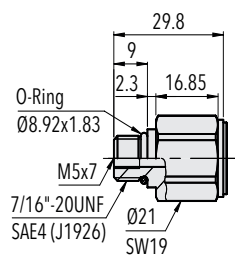

8270.XX.2X42.XX.XX.XX

8270.XX.2X24.XX.XX.XX

8270.XX.2X61.XX.XX.XX

Absolute pressure

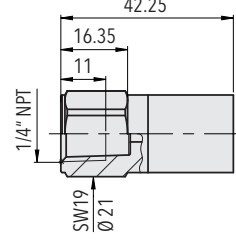
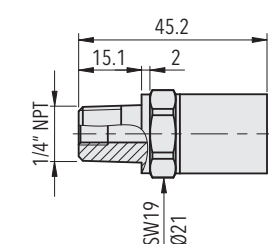
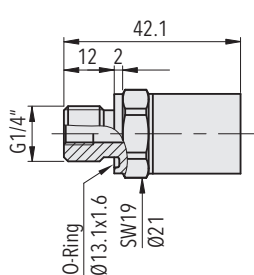

8270.XX.4X17.XX.XX.XX

8270.XX.4X30.XX.XX.XX

8270.XX.4X13.XX.XX.XX